

400DX-3 • 460DX-3

40" and 46" Commercial LCD Displays

Reliability always sends the right message.



Reliable 24/7 Continuous Operation
Innovative Samsung cooling technologies allow your message to be displayed with highly reliable 24/7 continuous operation.



Crisp Full HD Graphics and High Brightness
The 400DX-3/460DX-3 displays feature 1920 x 1080 high-resolution LCD panels, up to 700 nits brightness, 8ms response time and 10,000:1 dynamic contrast ratio, for impactful motion graphics full of sharp detail.



Versatile Connectivity
Broad connectivity enables flexible content options, including high bandwidth signals through the DisplayPort connection, and an RJ45 LAN port to simplify monitor control over your network.



Integrated Speakers
Built-in 10W stereo speakers complete the multimedia experience without having to purchase or wire external speakers.



Optional Integrated PC Module with MagicInfo™ Software
Add an optional Samsung SIM-NT integrated PC module to the 400DX-3/460DX-3 expansion slot for easy content control of multiple monitors via network.



Energy-Efficient
Samsung is committed to creating more efficient, more environmentally conscious technologies. From manufacturing to shipping to the way your product operates, we're always looking for a better way of doing things.

Because dependability is a business virtue worth having, the Samsung 400DX-3 and 460DX-3 full HD LCD displays deliver continuous 24/7 operation at a price you can afford. And all with bright, natural colors and crisp, clear text. So you'll always send the right message, whether displaying travel information, announcing a storewide sale or communicating critical information to students on campus. **Business. Innovated.**



For complete product information, visit samsung.com/prodisplay

400DX-3 460DX-3 Commercial LCD Displays



KEY SPECIFICATIONS

For complete product specifications, visit samsung.com/prodisplay

Product	Model Number	400DX-3	460DX-3	
Panel	Diagonal Size	40"	46"	
	Type	S-PVA 60Hz	S-PVA 60Hz	
	Resolution	1920 x 1080 (16:9)	1920 x 1080 (16:9)	
	Brightness (Typical/Max)	500 cd/m ² /700 cd/m ²	500 cd/m ² /700 cd/m ²	
	Contrast Ratio (Typical/Dynamic)	3,000:1/10,000:1	3,000:1/10,000:1	
	Response Time (Typical)	8ms	8ms	
	Viewing Angle (Horizontal/Vertical)	178°/178°	178°/178°	
Connectivity	PC Inputs	VGA (D-Sub 15-pin), DVI-D (in/out), DisplayPort	VGA (D-Sub 15-pin), DVI-D (in/out), DisplayPort	
	Video Inputs	Composite, HDMI (2), Component (D-sub 15-pin)	Composite, HDMI (2), Component (D-sub 15-pin)	
	Audio Inputs	RCA (L/R), Stereo Mini Jack (in/out)	RCA (L/R), Stereo Mini Jack (in/out)	
	Power Out	5V (for optional set back box tuner)	5V (for optional set back box tuner)	
	External Control	RJ45 LAN, RS232C (in/out)	RJ45 LAN, RS232C (in/out)	
Power	Power Supply	AC 100 - 240 V~ (+/- 10 %), 50/60 Hz	AC 100 - 240 V~ (+/- 10 %), 50/60 Hz	
	Power Consumption (Typ/Max)	200W/220W	230W/250W	
	Stand By Power (DPMS)	< 2 Watts	< 2 Watts	
Feature	Special	Lamp Error Detection, Brightness Sensor, Anti Retention, Temperature Sensor, RS232C/RJ45 MDC, Built-in Speaker (10W + 10W), Plug and Play (DDC2B), PIP/PBP, Video Wall (10x10), Pivot Display, Button Lock, Digital Daisy Chain, Smart Scheduling, Smart F/W Update	Lamp Error Detection, Brightness Sensor, Anti Retention, Temperature Sensor, RS232C/RJ45 MDC, Built-in Speaker (10W + 10W), Plug and Play (DDC2B), PIP/PBP, Video Wall (10x10), Pivot Display, Button Lock, Digital Daisy Chain, Smart Scheduling, Smart F/W Update	
	Media Player Type	SIM-NT (Slide in Module) - optional	SIM-NT (Slide in Module) - optional	
Dimensions	Product Dimension (Without Stand, W x H x D)	36.7" x 21.6" x 5.1"	42.0" x 24.6" x 5.1"	
	Shipment Dimension (W x H x D)	41.0" x 26.3" x 11.6"	46.8" x 29.7" x 12.4"	
Weight	Product Weight	37.4 lbs.	46.6 lbs.	
	Shipment Weight	48.4 lbs.	56.5 lbs.	
Mechanical Specs	VESA Mount	600 x 400 mm	600 x 400 mm	
	Bezel Width	20 mm	20 mm	
Operation	Operating Temp/Humidity	0°C - 40°C / 10 - 80%	0°C - 40°C / 10 - 80%	
	Recommended Run Time	24/7 Continuous	24/7 Continuous	
Accessories	Included	Quick Setup Guide, Warranty Card, Application CD, D-Sub cable, Power Cord, Remote Controller, Batteries	Quick Setup Guide, Warranty Card, Application CD, D-Sub cable, Power Cord, Remote Controller, Batteries	
	Optional	Stand	STN-L3255D	STN-L3255D
		Mount	WMN5770D	WMN5770D
		Specialty	STN-520WE (Welcome Board), SIM-NT (PC Module), SBB-DT3 (Tuner Accessory)	STN-520WE (Welcome Board), SIM-NT (PC Module), SBB-DT3 (Tuner Accessory)
Service	Standard Warranty	3-Year Onsite Parts and Labor	3-Year Onsite Parts and Labor	

GREEN MANAGEMENT

Emission Standard	EMC	EMC
Energy Star® 5.0 Compliant	■	■
ROHS Compliant	■	■
Packaging Recyclability	■	■

CONNECTIVITY

1. IR Loop-Out
2. DVI Out
3. D-Sub In
4. DVI In
5. RGB/DVI/DP/HDMI Audio In
6. DisplayPort
7. DC 5V Out
8. HDMI 1
9. HDMI 2
10. CVBS AV In
11. RJ45 Remote Control
12. Audio Out
13. RS232C In
14. RS232C Out

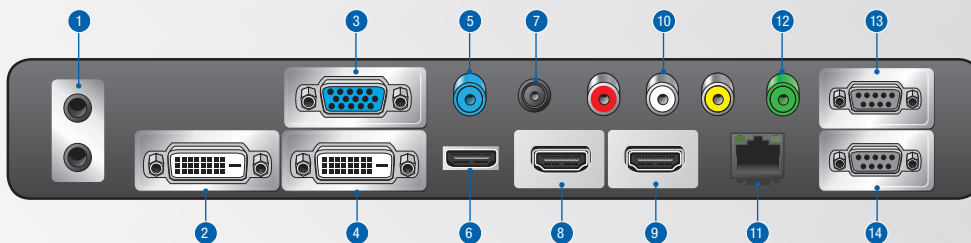

Available at:  NETWORK Spectrum®

Call: 301-733-0657

Email: sales@networkspectrum.com

Other products available at:

www.networkspectrum.com/gsaschedule/

